

ELIJAH TOOLING TOMBSTONES



Overview

Made to order tombstones are used in high-speed horizontal machining cells to hold/locate stock or other tooling for manufacturing. We offer affordable, precise, raw or machined tombstones made to customer specifications. Tombstone sizes range from 300mm to 1000mm, 2-sided, 4-sided, Window Frames.

Applications

Modular grid patterns incorporate any combination of bored, threaded, bushed, threaded insert, multi-purpose hole, or Invert-A-Bolt™ fastener locations; ZipFixture™ setups (see photo below), vise setups, modular fixture plates and other tooling implements.

General Specifications

Material: Cast iron, cast aluminum, steel weldment

Accuracy: Class 1 Tolerances

Flatness: .0008/12

Parallelism: .0008/12

Perpendicularity: .0008/12

Surface Finish: 63 RMS

Face Thickness: ± 0.01

Tapped Holes: ± 0.005

Bored/ Bushed Hole, Hole to Hole: ± 0.0005

Locating: Edge (with hardened wear pads) or Center (50 mm bushing)

2-SIDED TOMBSTONES

Call 877-462-BOLT for a quote

Raw Cast Iron



Specifications:

- Gray Cast Iron, ASTM 45
- Not machined
- Quantity discounts of 2 and up

Sizing Options (in mm):

300, 400, 500, 630, 800, 1000

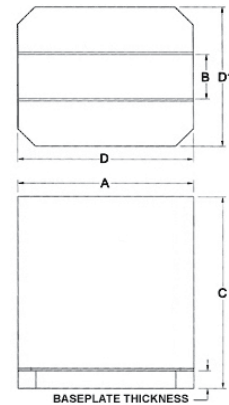

Machined Base, Top with Holes



Specifications:

- Gray Cast Iron, ASTM 45
- Not machined
- Quantity discounts of 2 and up

Sizing Options (in mm):

300, 400, 500, 630, 800

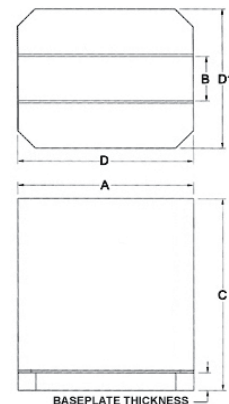

Machined Base, Sides, Top with Holes



Specifications:

- Gray Cast Iron, ASTM 45
- Not machined
- Quantity discounts of 2 and up

Sizing Options (in mm):

300, 400, 500, 630, 800

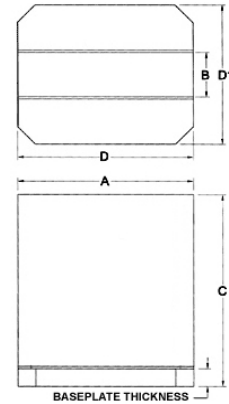

Modular Tombstone-Multi-Purpose Holes in Grid Pattern

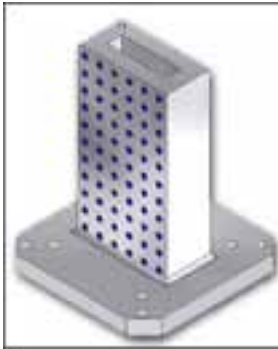

Specifications:

- Gray Cast Iron, ASTM 45
- Not machined
- Quantity discounts of 2 and up

Sizing Options (in mm):

Call for quote

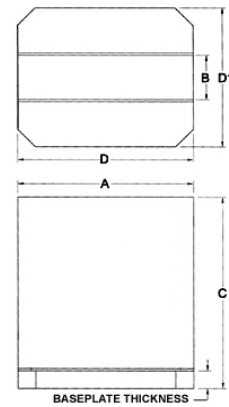

The Ultimate Modular Tombstone

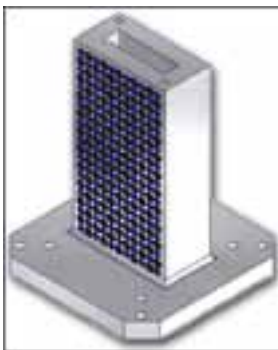

Specifications:

- Gray Cast Iron, ASTM 45
- Not machined
- Quantity discounts of 2 and up

Sizing Options (in mm):

Call for Quote

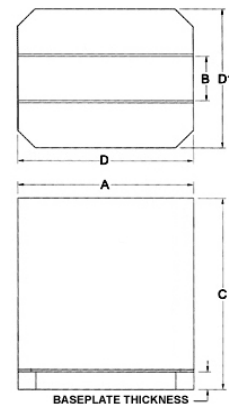

4-SIDED TOMBSTONES

Call 877-462-BOLT for a quote

Raw Cast Iron



Specifications:

- Gray Cast Iron, ASTM 45
- Not machined
- Quantity discounts of 2 and up

Sizing Options (in mm):

300, 400, 630, 800, 1000

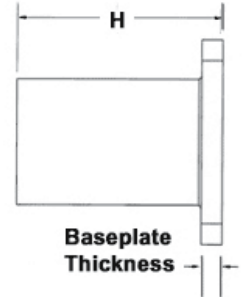
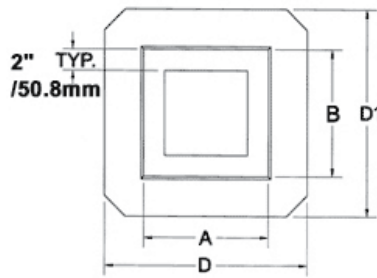

Machined Base, Top with Holes



Specifications:

- Gray Cast Iron, ASTM 45 or 6061-T6 Cast Aluminum
- Machined Base
- Hold down holes
- Lift holes
- Overall height machined to +/- 0.030"
- Quantity discounts of 2 and up

Sizing Options (in mm):

300, 400, 630, 800, 1000

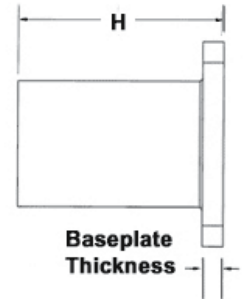
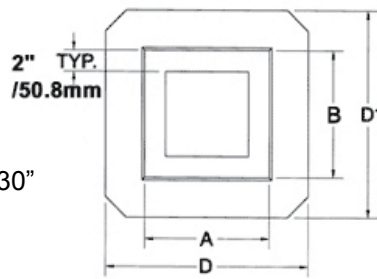
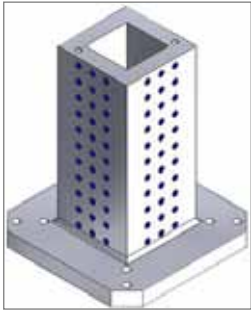

Figure at right is a 12x12 ZipFixture™ Tombstone.

Multi-Purpose Holes with Grid



Specifications:

- Gray Cast Iron, ASTM 45 or 6061-T6 Cast Aluminum
- Machined Base
- Hold down holes
- Lift holes
- Overall height machined to +/- 0.030"
- Quantity discounts of 2 and up

Tolerances:

- Flatness .0008"/12"
- Parallelism .0008"/12"
- Perpendicularity .001"/12"
- Face Thickness +/- .0012"
- Surface Finish 63 RMS

Systems:

- 1/2"=.500 Bushings, 1/2"-13 Threaded Inserts (& AA02-015-001C IVB Fasteners Ultimate)
- 5/8"=.625 Bushings, 5/8"-11 Threaded Inserts (& AA03-150-001C IVB Fasteners Ultimate)

Sizing Options (in mm):

500, 630

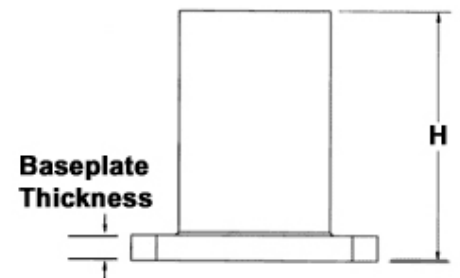
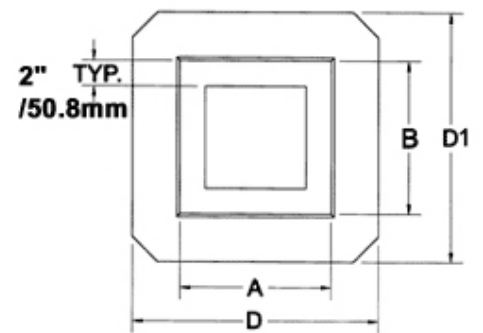

The Ultimate Modular Tombstone

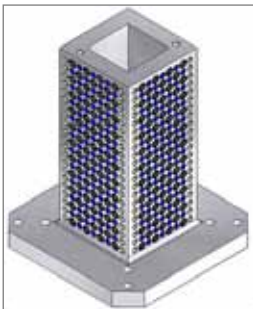

Specifications:

- Gray Cast Iron, ASTM 45 or 6061-T6 Cast Aluminum
- Machined Base
- Hold down holes
- Lift holes
- Overall height machined to +/- 0.030"
- Quantity discounts of 2 and up

Tolerances:

- Flatness .0008"/12"
- Parallelism .0008"/12"
- Perpendicularity .001"/12"
- Face Thickness +/- .0012"
- Surface Finish 63 RMS

Systems:

- 1/2"=.500 Bushings, 1/2"-13 Threaded Inserts (& AA02-015-001C IVB Fasteners Ultimate)
- 5/8"=.625 Bushings, 5/8"-11 Threaded Inserts (& AA03-150-001C IVB Fasteners Ultimate)

Sizing Options (in mm):

500, 630

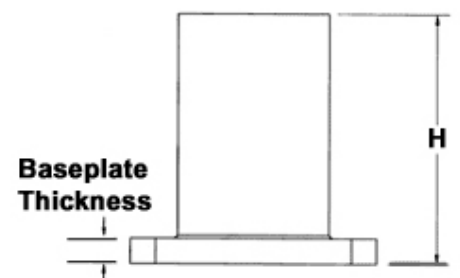
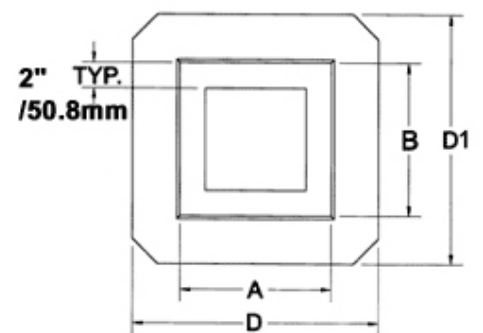

WINDOW-FRAMED TOMBSTONES

Raw Cast Iron

Call 877-462-BOLT for a quote



Machined Base, Top with Holes

Call 877-462-BOLT for a quote

Machined Base, Sides, Top with Holes

Call 877-462-BOLT for a quote

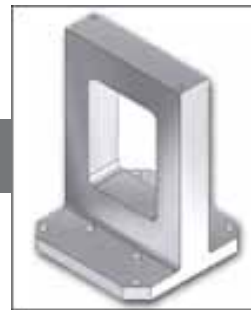

Modular Tombstone-Multi-Purpose Holes in Grid pattern

Call 877-462-BOLT for a quote